

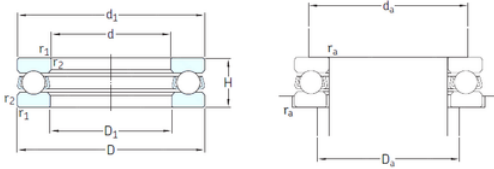

# BROWNING BEARING COMPANY



## skf 51201 bearing

Bearing No. 51201

Size	12x28x11 mm
Bore Diameter	12 mm
Outer Diameter	28 mm
Width	11 mm
d	12 mm
D	28 mm
H	11 mm
d1	28 mm
r1 min.	0,6 mm
r2 min.	0,6 mm
D1	14 mm
da min.	22 mm
Da max.	18 mm
ra max.	0,6 mm
Weight	0,034 Kg
Basic dynamic load rating (C)	13,3 kN
Basic static load rating (C0)	20,8 kN
Fatigue load limit (Pu)	0,765
Reference speed	8000 r/min
Limiting speed	11000 r/min
Category	Thrust Ball Bearing
Inventory	0.0
Manufacturer Name	SKF
Minimum Buy Quantity	N/A
Weight / Kilogram	0.036
EAN	7316577006769

51201 Bearing 2D drawings and 3D CAD models



## BROWNING BEARING COMPANY

Product Group	B00308
Rolling Element	Ball Bearing
Thrust Bearing	Yes
Single or Double Direction	Single Direction
Banded	No
Cage Material	Steel
Precision Class	ABEC 1   ISO P0
Component Description	Roller Assembly Plus Raceways
Other Features	Single Row
Long Description	12MM Bore 1; 14MM Bore 2; 28MM Outside Diameter; 11MM Height; Ball Bearing; Single Direction; Not Banded; Steel Cage; ABEC 1   ISO P0 Precision
Inch - Metric	Metric
Category	Thrust Ball Bearings
UNSPSC	31171507
Harmonized Tariff Code	8482.10.50.08
Noun	Bearing
Keyword String	Ball Thrust
Manufacturer URL	<a href="http://www.skf.com">http://www.skf.com</a>
Manufacturer Item Number	51201
Weight / LBS	0.08
Height	0.433 Inch   11 Millimeter
Bore 1	0.472 Inch   12 Millimeter
Bore 2	0.551 Inch   14 Millimeter
Overall Height with Aligning Washer	0 Inch   0 Millimeter
Outside Diameter	1.102 Inch   28 Millimeter
bore diameter:	12 mm
static load capacity:	20.8 kN
outside diameter:	28 mm



## BROWNING BEARING COMPANY

dynamic load capacity:	13.3 kN
overall width:	11 mm
maximum rpm:	11000 RPM
thrust bearing type:	Single-Direction
cage material:	Steel
outside diameter design:	Straight
fillet radius:	0.6 mm
separable or banded:	Separable
series:	512
precision rating:	ABEC 1 (ISO Class Normal)
$d_1$	28 mm
$D_1$	14 mm
$r_{1,2}$ min.	0.6 mm
$d_a$ min.	22 mm
$D_a$ max.	18 mm
$r_a$ max.	0.6 mm
Basic dynamic load rating C	13.3 kN
Basic static load rating $C_0$	20.8 kN
Fatigue load limit $P_u$	0.765 kN
Minimum load factor A	0.0022
Mass bearing (including seat washer where applicable)	0.034 kg