

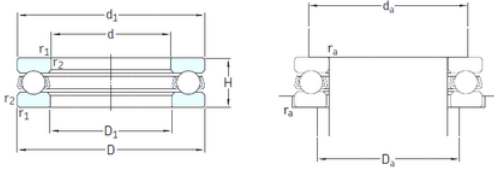

# BROWNING BEARING COMPANY



## skf 51111 bearing

Bearing No. 51111

Size	55x78x16 mm
Bore Diameter	55 mm
Outer Diameter	78 mm
Width	16 mm
d	55 mm
D	78 mm
H	16 mm
d1	78 mm
r1 min.	0,6 mm
r2 min.	0,6 mm
D1	57 mm
da min.	69 mm
Da max.	64 mm
ra max.	0,6 mm
Weight	0,23 Kg
Basic dynamic load rating (C)	30,2 kN
Basic static load rating (C0)	81,5 kN
Fatigue load limit (Pu)	3
Reference speed	3800 r/min
Limiting speed	5300 r/min
Category	Thrust Ball Bearing
Inventory	0.0
Manufacturer Name	SKF
Minimum Buy Quantity	N/A
Weight / Kilogram	0.232
EAN	7316576677434

51111 Bearing 2D drawings and 3D CAD models



## BROWNING BEARING COMPANY

Product Group	B00308
Rolling Element	Ball Bearing
Thrust Bearing	Yes
Single or Double Direction	Single Direction
Banded	No
Cage Material	Steel
Precision Class	ABEC 1   ISO P0
Component Description	Roller Assembly Plus Raceways
Other Features	Single Row
Long Description	55MM Bore 1; 57MM Bore 2; 78MM Outside Diameter; 16MM Height; Ball Bearing; Single Direction; Not Banded; Steel Cage; ABEC 1   ISO P0 Precision
Inch - Metric	Metric
Category	Thrust Ball Bearings
UNSPSC	31171507
Harmonized Tariff Code	8482.10.50.08
Noun	Bearing
Keyword String	Ball Thrust
Manufacturer URL	<a href="http://www.skf.com">http://www.skf.com</a>
Manufacturer Item Number	51111
Weight / LBS	0.512
Overall Height with Aligning Washer	0 Inch   0 Millimeter
Bore 1	2.165 Inch   55 Millimeter
Bore 2	2.244 Inch   57 Millimeter
Height	0.63 Inch   16 Millimeter
Outside Diameter	3.071 Inch   78 Millimeter
bore diameter:	55 mm
static load capacity:	81.5 kN
outside diameter:	78 mm



## BROWNING BEARING COMPANY

dynamic load capacity:	30.2 kN
overall width:	16 mm
maximum rpm:	5300 RPM
thrust bearing type:	Single-Direction
cage material:	Steel
outside diameter design:	Straight
fillet radius:	0.6 mm
separable or banded:	Separable
series:	511
precision rating:	ABEC 1 (ISO Class Normal)
$d_1$	78 mm
$D_1$	57 mm
$r_{1,2}$ min.	0.6 mm
$d_a$ min.	69 mm
$D_a$ max.	64 mm
$r_a$ max.	0.6 mm
Basic dynamic load rating C	30.2 kN
Basic static load rating $C_0$	81.5 kN
Fatigue load limit $P_u$	3 kN
Minimum load factor A	0.039
Mass bearing (including seat washer where applicable)	0.23 kg